

Notes:

Wall Types

All works are Contractor Design. The following partition specifications are for information only. Partition duty, fire rating and acoustic requirements are as noted below.

**WT01 -**  
 GypWall Classic A206199S 136mm partition thickness  
 Gypframe 70 S 50 'C' Stud at 600 centres  
 Gyproc SoundBloc (2 x 15) + 2mm Thistle MultiFinish  
 Gyproc SoundBloc (2 x 15) + 2mm Thistle MultiFinish  
 25mm Isover Acoustic Partition Roll (APR 1200)  
 90FR Insulation and Integrity (60FR required)  
 Suitable for height up to 4900 (c.3800mm required)  
 Severe duty rating  
 55 RwDB

**WT02**  
 GypWall Classic A206015 122mm deep  
 Gypframe 70 S 50 'C' Stud at 600 centres  
 Gyproc WallBoard (1 x 12.5)  
 Gyproc WallBoard (1 x 12.5)  
 60FR Insulation and Integrity (suitable for height up to 4600)  
 Severe duty rating  
 45 RwDB

**WT03**  
 Glazed partition screens. Timber screens to a height of approx. 3000mm with wall construction above. Free standing glazed screen between Rooms 1 and 2. Contractor design - refer to screen drawing for design intent. Translucent etched glass to a height of 1600mm. Contractor to submit proposals for client approval. Refer to Schedule of work for required priced options.

**WTEX**  
 Existing walls to be retained.

**Client information**  
 Clients to confirm locations where any additional power sockets are required.

Clients to confirm requirements for additional units in kitchen. Potential for off the shelf products installed by client.

Lighting to be as existing fittings, however additional fittings will be required in main spaces and corridor. Emergency fittings to be clarified by contractor.

Existing fire alarm system category to be confirmed by client as this will inform fire strategy. Additional smoke detectors may be required. Contractor to assume category L1 to be provided.

Notes:

Part M

- All doors to public spaces must have:
- a minimum 825mm clear entrance when approached at right angles or 800mm when approached straight on
  - an opening force compliant with Part M with no power operated mechanism required
  - visually contrasting door frame
  - a 300mm nib to the leading edge
- in accordance with Part M1 / 2 of the Building Regulations

The corridor must retain a clear width of 1200mm along the length.

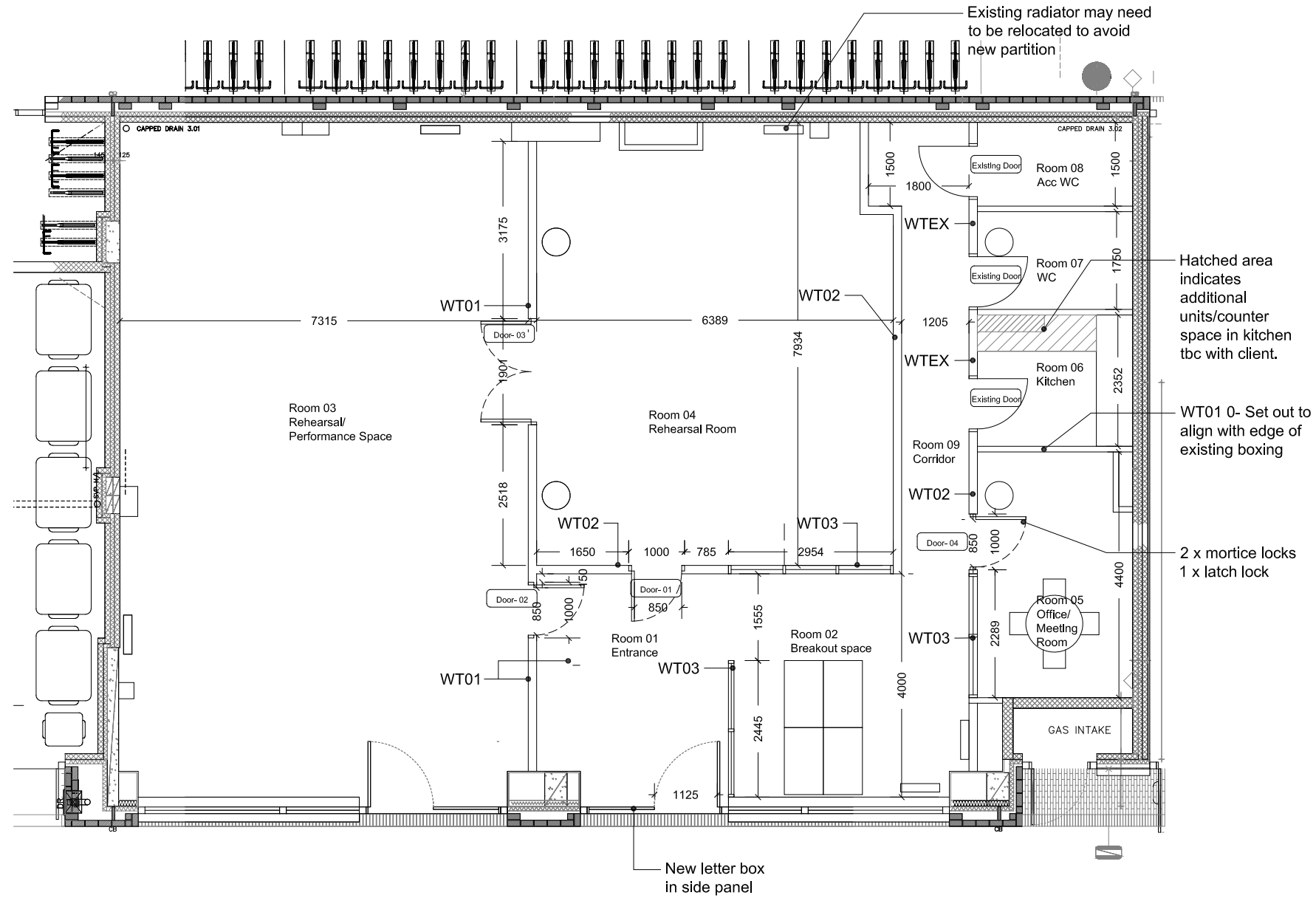

**LYNDON GOODE ARCHITECTS**  
 Lyndon Goode Architects Limited © 2016  
 For general enquiries: studio@lydongoode.com  
 For project enquiries: project@lydongoode.com

Do not scale from this drawing. Contractor to check and verify all building and site dimensions levels and sewer invert levels at connection points before work starts.

This drawing is to be read and checked in conjunction with information provided by the engineers and other specialists.  
 All drawings to be read in conjunction with the schedule of works

REV	DATE	DESCRIPTION	KEY PLAN
P1	12.03.20	Issue for Building Control Review	
T1	20.08.20	Issue for Tender	

INFORMATION

NOTE: This drawing is design intent information only. The Contractor shall be responsible for all aspects of the design and development of the scheme for construction. This drawing is not to be used for construction.

PROJECT  
**Unit C Kings Crescent**

DRAWING TITLE  
**Ground Floor Plan Proposed**

SCALE  
**1:100 @ A3**

DRAWING NUMBER  
**HAC|01|100|01**

REV.  
**T1**

**TENDER**